

INSTRUCTIONS FOR USE

Ref: APEX-IFU-T2C2000

Description Anaesthetic Tray 2-Compartment 2000ml Disposable Medical Pulp

Product Part Number T2C2000

Ordering Item Code 101APPT2C2000

Product Image



Intended Use

For the purpose of patient treatment and monitoring, the Food Grade Anaesthetic Tray with 2-Compartment is made from eco-friendly biodegradable sugarcane bagasse, intended for use as multi-purpose tray to carry ampoules at the small compartment, surgical instruments, dressings, wipes, creams and other medical items at the large compartment. It is designed with smooth inner finishing and meshed outer surface for extra grip.

Caution

Do not pour alcohol based solutions into the 2-Compartment Tray.

User Guide

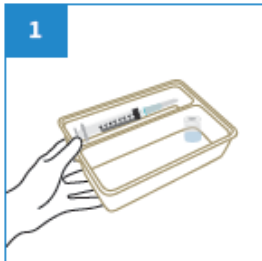

1
Place surgical items on the Anaesthetic Tray.

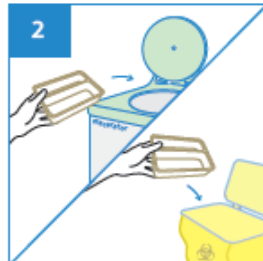

2
After use, dispose the Anaesthetic Tray into macerator or appropriate waste bins.

Disclaimer:

All products specifications, illustrations, drawings, images, dimensions, performance data and other information on our Instructions for Use or made available by us are subjected to change without notice and they are intended to represent no more than a general illustration of the products intended use and their features and do not constitute a warranty or representation by us that the products will conform with the same. Products that are shipped to you may vary from these images or specifications.

Rev2(1123)

