

INSTRUCTIONS FOR USE

Ref: APEX-IFU-MSP1300

Description Midi Slipper Pan Liner 1300ml Disposable Medical Pulp

Product Part Number MSP1300

Ordering Item Code 100APPMSP13000

Product Image



Intended Use For the purpose of patient treatment and monitoring, the Midi Slipper Pan Liner Graduated with 1.3L rated capacity is made from eco-friendly biodegradable kraft material, intended for use as fracture receptacle for urine and/or faeces. To use the midi slipper pan liner on the bed, place it over a plastic support.

Caution Do not dispose the plastic support into macerator

User Guide

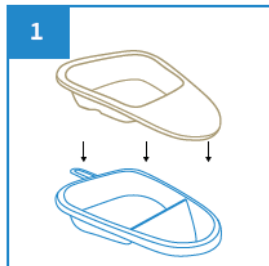

Place the Midi Slipper Pan Liner over the plastic midi slipper pan support.

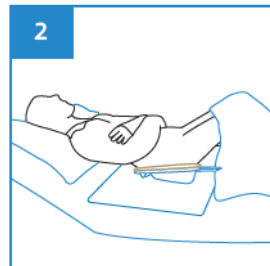

Slide the Midi Slipper Pan Liner with support under the buttock. To prevent spills, place a sheet of incontinence pad under the Midi Slipper Pan.

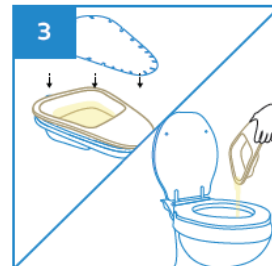

After use, remove the Midi Slipper Pan Liner with support, place a lid cover over it to contain the odour and sight.

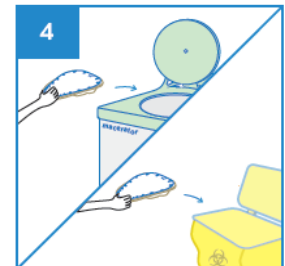

Dispose the Midi Slipper Pan Liner directly into macerator or empty the content from midi slipper pan liner before disposing into appropriate waste bins.

Disclaimer:

All products specifications, illustrations, drawings, images, dimensions, performance data and other information on our Instructions for Use or made available by us are subjected to change without notice and they are intended to represent no more than a general illustration of the products intended use and their features and do not constitute a warranty or representation by us that the products will conform with the same. Products that are shipped to you may vary from these images or specifications.

Rev2(1123)

