

INSTRUCTIONS FOR USE

Ref: APEX-IFU-KNS0950

Description Kidney Dish Food Grade 950ml Disposable Medical Pulp

Product Part Number KNS0950

Ordering Item Code 101APPKNS0950

Product Image



Intended Use For the purpose of patient treatment and monitoring, the Food Grade Kidney Dish with 950ml rated capacity is made from eco-friendly biodegradable sugarcane bagasse, intended for use as multi-purpose dish to carry surgical instruments, dressings, wipes, creams and other medical items. It is designed with smooth inner finishing and meshed outer surface for extra grip.

Caution Do not pour alcohol based solutions into the Kidney Dish.

User Guide



Place surgical items on the Kidney Dish.

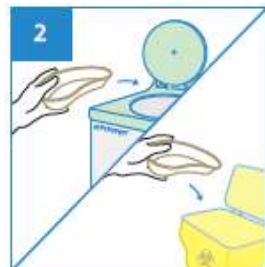

After use, dispose the Kidney Dish into macerator or appropriate waste bins.

Disclaimer:

All products specifications, illustrations, drawings, images, dimensions, performance data and other information on our Instructions for Use or made available by us are subjected to change without notice and they are intended to represent no more than a general illustration of the products intended use and their features and do not constitute a warranty or representation by us that the products will conform with the same. Products that are shipped to you may vary from these images or specifications.

Rev2(1123)

