

## INSTRUCTIONS FOR USE

Ref: APEX-IFU-AUB1000

Description Adaptor Urinal Bulbous Disposable Medical Pulp

Product Part Number AUB1000

Ordering Item Code 100APPAUB1000

Product Image



Intended Use

For the purpose of patient treatment and monitoring, the Adaptor for Urinal Bulbous is made from eco-friendly biodegradable kraft material, intended for use as an adaptor for converting male urinal bulbous to female urinal bulbous. The contoured opening is designed to fit comfortably when placed between the legs of female patients in either sitting or laying positions.

User Guide



**1**  
Insert Adaptor into Male Urinal Bulbous converting it as Female Urinal Bulbous



**2**  
Place the Female Urinal Bulbous between the legs and cover completely for urination.

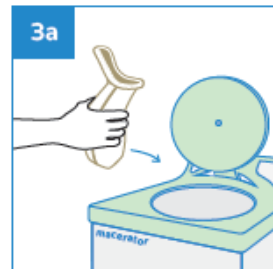

**3a**  
Dispose the Female Urinal Bulbous directly into macerator or empty the content from the Female Urinal Bulbous before disposing into appropriate waste bins.

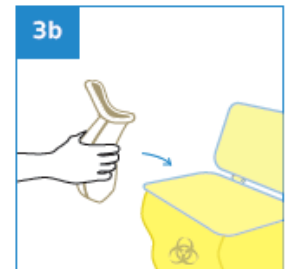

**Disclaimer:**

All products specifications, illustrations, drawings, images, dimensions, performance data and other information on our Instructions for Use or made available by us are subjected to change without notice and they are intended to represent no more than a general illustration of the products intended use and their features and do not constitute a warranty or representation by us that the products will conform with the same. Products that are shipped to you may vary from these images or specifications.

Rev2(1123)

