



APEX PULP

Manufacturer of Moulded Pulps

GENERAL WASH BOWL 3000ML

Eco-Friendly Medical Pulp



Made from
BIODEGRADABLE
Double Lined Kraft

Designed for Single Use to
Reduce Risk of Infection



Our disposable General Wash Bowl 3L is ideal for rinsing of towels and as container for large volume of liquid. It is easy to use and environmentally friendly. Designed for single use so as to reduce the risk of infection.

Suitable for



Hospitals



Nursing Homes



Personal Use



Medical Clinics



Disability Homes

User Guide



Dispense and apply soap directly on the patient's body or on a towel

Caution
Do not dispense soap directly into the wash bowl



Rinse the towel in the General Wash Bowl, and wipe the patient body clean

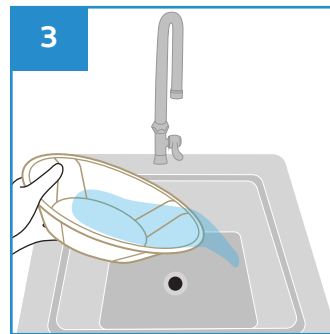

After use, empty the contents into the sink

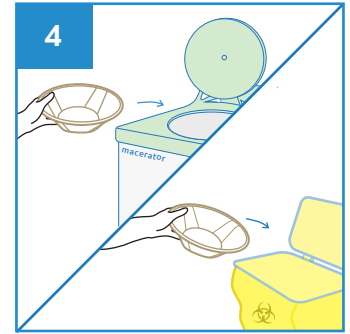

Dispose the General Wash Bowl directly into macerator or into appropriate waste bins.

Note: DO NOT dispose the towel into macerator.



Stackable



Water Retention



Macerator Friendly



Eco-Friendly



Recyclable

PRODUCT DESCRIPTION	PRODUCT SIZE	PACKAGING	CARTON DIMENSION	ORDER CODE
General Wash Bowl 3000ml	Ø300 x 95mm	100 pcs per carton	720 x 370 x 310 mm	100APPGWB3000



Manufactured in accordance with PAS29:1999
Disposable Pulp Products For Use in Healthcare

Rev0(1129)EN

