



**APEX PULP**

Manufacturer of Moulded Pulps

# ADAPTOR FOR URINAL BULBOUS

## Eco-Friendly Medical Pulp



Made from  
**BIODEGRADABLE**  
Double Lined Kraft

Designed for Single Use to  
Reduce Risk of Infection



The Adaptor for Urinal Bulbous is made from eco-friendly biodegradable kraft material, intended for use as an adaptor for converting male urinal bulbous to female urinal bulbous. The contoured opening is designed to fit comfortably when placed between the legs of female patients in either sitting or laying positions.

Manufactured as single-use disposable medical pulp to meet the requirement to hold water and/or human waste for a minimum period of four hours at an initial temperature of 35°C. Suitable for disposal into macerator which complies with PAS29:1999 "Disposable Pulp For Use in Healthcare".

**Suitable for**



Hospitals



Nursing Homes



Personal Use



Medical Clinics



Disability Homes

**User Guide**

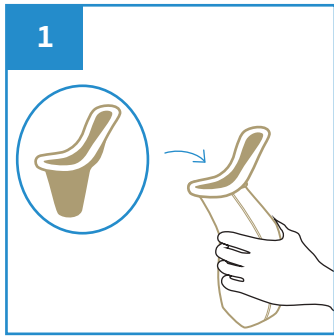

1  
Insert Adaptor into Male Urinal Bulbous converting it as Female Urinal Bulbous

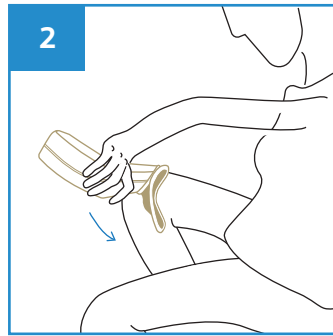

2  
Place the Female Urinal Bulbous between the legs and cover completely for urination.

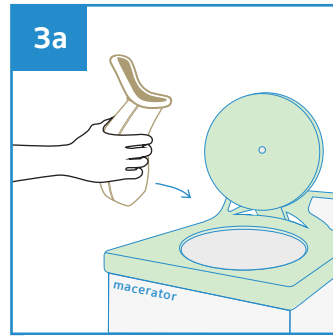

3a  
Dispose the Female Urinal Bulbous directly into macerator or empty the content from the Female Urinal Bulbous before disposing into appropriate waste bins.

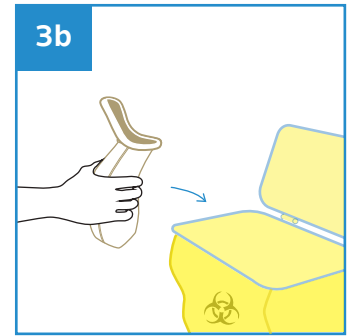

Stackable



Water Retention



Macerator Friendly



Eco-Friendly



Recyclable

PRODUCT DESCRIPTION	PRODUCT SIZE	PACKAGING	CARTON DIMENSION	ORDER CODE
Adaptor for Urinal Bulbous (Female Urinal)	120 x 63 x 125 mm	200 pcs per carton	510 x 260 x 210 mm	100APPAUB1000



Manufactured in accordance with PAS29:1999  
Disposable Pulp Products For Use in Healthcare

Rev1(1123)EN

