

INSTRUCTIONS FOR USE

Ref: APEX-IFU-MSP1300

Description	Midi Slipper Pan Liner 1300ml Disposable Medical Pulp
Product Part Number	MSP1300
Ordering Item Code	100xxxMSP1300 (xxx – To be assigned upon order)
UDI-DI	95510204300212

Product Image



Intended Use	For patient treatment and monitoring, the Midi Slipper Pan Liner Graduated with 1.3L rated capacity is made from eco-friendly biodegradable kraft material, intended for use as fracture receptacle for urine and/or faeces. To use the midi slipper pan liner on the bed, place it over a plastic support. Do NOT dispose the plastic support into macerator.
--------------	---

Storage	Keep in a cool, dry place, away from heat, flames, and sunlight.
---------	--

User Guide

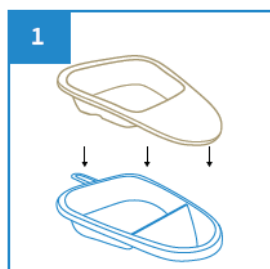

Place the Midi Slipper Pan Liner over the plastic midi slipper pan support.

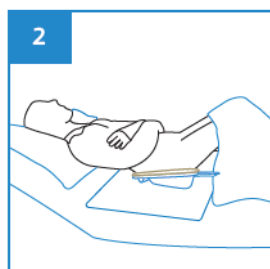

Slide the Midi Slipper Pan Liner with support under the buttock. To prevent spills, place a sheet of incontinence pad under the Midi Slipper Pan.

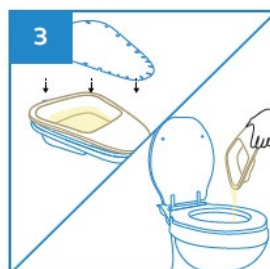

After use, remove the Midi Slipper Pan Liner with support, place a lid cover over it to contain the odour and sight.

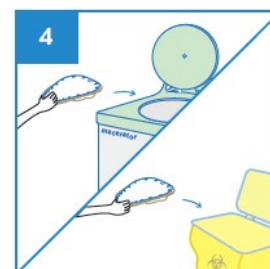

Dispose the Midi Slipper Pan Liner into the macerator, or empty the contents before disposing into appropriate waste bins.



WARNING

Any serious incident related to the device must be reported to the manufacturer and to the competent authority of the Member State in which the user is established.

Disclaimer:

All products specifications, illustrations, drawings, images, dimensions, performance data and other information on our Instructions for Use or made available by us are subjected to change without notice and they are intended to represent no more than a general illustration of the products intended use and their features and do not constitute a warranty or representation by us that the products will conform with the same. Products that are shipped to you may vary from these images or specifications.



APEX PULP Pte Ltd

Company Registration No.: 200715327H
132 Joo Seng Road #04-01. Singapore 368358
Tel: +65 6817 8969 | Fax: +65 6636 9813
www.apexpulp.com | sales@apexpulp.com

