

## INSTRUCTIONS FOR USE

Ref: APEX-IFU-KNS0950

Description	Kidney Dish Food Grade 950ml Disposable Medical Pulp
Product Part Number	KNS0950
Ordering Item Code	101xxxKNS0950 (xxx – To be assigned upon order)
UDI-DI	95510204301516

### Product Image



Intended Use	For patient treatment and monitoring, the Food Grade Kidney Dish with 950ml rated capacity is made from eco-friendly biodegradable sugarcane bagasse, intended for use as multi-purpose dish to carry surgical instruments, dressings, wipes, creams and other medical items. It is designed with smooth inner finishing and meshed outer surface for extra grip. Do <b>NOT</b> pour alcohol-based solutions into the Kidney Dish.
--------------	--

Storage	Keep in a cool, dry place, away from heat, flames, and sunlight.
---------	--

### User Guide

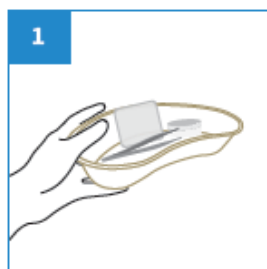

Place surgical items on the Kidney Dish.

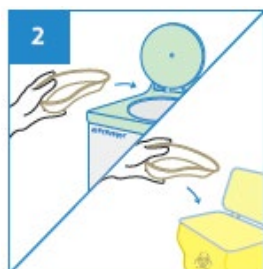

After use, dispose the Kidney Dish into macerator or appropriate waste bins.



### WARNING

Any serious incident related to the device must be reported to the manufacturer and to the competent authority of the Member State in which the user is established.

### Disclaimer:

All products specifications, illustrations, drawings, images, dimensions, performance data and other information on our Instructions for Use or made available by us are subjected to change without notice and they are intended to represent no more than a general illustration of the products intended use and their features and do not constitute a warranty or representation by us that the products will conform with the same. Products that are shipped to you may vary from these images or specifications.



**APEX PULP Pte Ltd**

Company Registration No.: 200715327H  
132 Joo Seng Road #04-01. Singapore 368358  
Tel: +65 6817 8969 | Fax: +65 6636 9813  
www.apexpulp.com | sales@apexpulp.com

