

INSTRUCTIONS FOR USE

Ref: APEX-IFU-GPP2000

Description	General Purpose Pot 2000ml Disposable Medical Pulp
Product Part Number	GPP2000
Ordering Item Code	100xxxGPP2000 (xxx – To be assigned upon order)
UDI-DI	95510204301134

Product Image



Intended Use	For patient treatment and monitoring, the General Purpose Pot Graduated with 2L rated capacity is made from eco-friendly biodegradable kraft material, intended for use as container to drain urine and/or to determine the amount of urine or fluid as it is marked with graduation levels ranging from 50ml to 2000ml.
--------------	--

Storage	Keep in a cool, dry place, away from heat, flames, and sunlight.
---------	--

User Guide

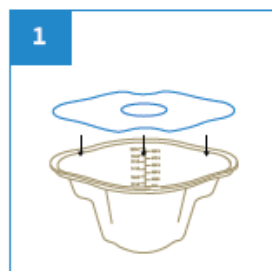

1 Place lid over General Purpose Pot.

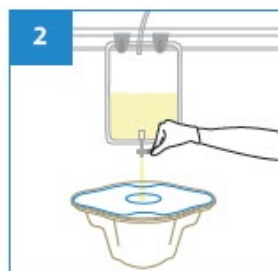

2 Place General Purpose Pot under urinal bag. Drain urine through the lid hole to prevent splashes.



3 To measure contents, remove the lid and read the volume from graduated markings.

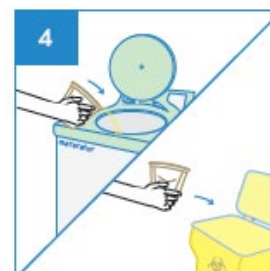

4 Dispose the General Purpose Pot with lid directly into macerator or into appropriate waste bins.



WARNING

Any serious incident related to the device must be reported to the manufacturer and to the competent authority of the Member State in which the user is established.

Disclaimer:

All products specifications, illustrations, drawings, images, dimensions, performance data and other information on our Instructions for Use or made available by us are subjected to change without notice and they are intended to represent no more than a general illustration of the products intended use and their features and do not constitute a warranty or representation by us that the products will conform with the same. Products that are shipped to you may vary from these images or specifications.



APEX PULP Pte Ltd

Company Registration No.: 200715327H
132 Joo Seng Road #04-01. Singapore 368358
Tel: +65 6817 8969 | Fax: +65 6636 9813
www.apexpulp.com | sales@apexpulp.com

