

INSTRUCTIONS FOR USE

Ref: APEX-IFU-BPG2000

Description	Bedpan Liner Graduated 2000ml Disposable Medical Pulp
Product Part Number	BPG2000
Ordering Item Code	100xxxBPG2000 (xxx – To be assigned upon order)
UDI-DI	95510204300076

Product Image



Intended Use

For patient treatment and monitoring, the Bedpan Liner Graduated with 2L rated capacity is made from eco-friendly biodegradable kraft material, intended for use as receptacle for urine and/or faeces. To use the bedpan liner, place it over a plastic or moulded pulp support. Alternatively, the bedpan liner can also be placed under commode chair for toileting. Do **NOT** dispose the plastic support into macerator.

Storage

Keep in a cool, dry place, away from heat, flames, and sunlight.

User Guide

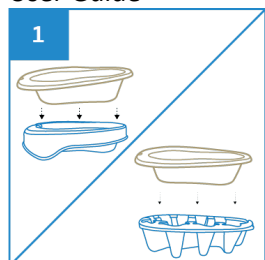

Place Bedpan Liner over the plastic or disposable moulded pulp bedpan support.

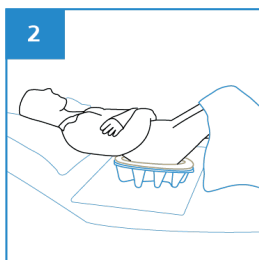

Slide the Bedpan Liner with support under the buttock. To prevent spills, place a sheet of incontinence pad under the bedpan.

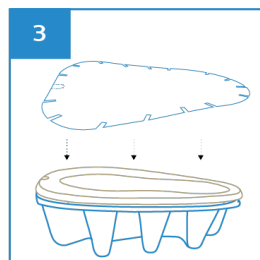

After use, remove the Bedpan Liner with support, place a lid cover over it to contain the odour and sight.

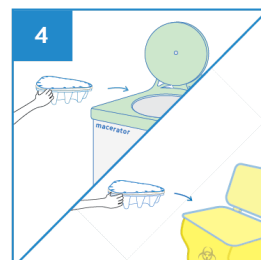

Dispose the Bedpan Liner with disposable support directly into macerator or empty the content from Bedpan Liner before disposing into appropriate waste bins.



WARNING

Any serious incident related to the device must be reported to the manufacturer and to the competent authority of the Member State in which the user is established.

Disclaimer:

All products specifications, illustrations, drawings, images, dimensions, performance data and other information on our Instructions for Use or made available by us are subjected to change without notice and they are intended to represent no more than a general illustration of the products intended use and their features and do not constitute a warranty or representation by us that the products will conform with the same. Products that are shipped to you may vary from these images or specifications.



APEX PULP Pte Ltd

Company Registration No.: 200715327H
132 Joo Seng Road #04-01. Singapore 368358
Tel: +65 6817 8969 | Fax: +65 6636 9813
www.apexpulp.com | sales@apexpulp.com

